



Pamukkale University  
Faculty of Engineering  
Department of Textile Engineering



# Introductory Presentation

Address: Kınıklı Yerleşkesi, 20070 Denizli /Türkiye  
Phone: +90 (258) 296 31 01  
Fax: +90 (258) 296 32 62  
E-mail: [tekstil@pamukkale.edu.tr](mailto:tekstil@pamukkale.edu.tr)  
Web: <http://www.pau.edu.tr/tekstil/en>



**2013-2014**  
**PAU Faculty of Engineering**

# Foundation

The department was established in 1995.  
Current educational team has:

- ▶ 5 Associate Professors,
- ▶ 5 Assistant Professors,
- ▶ 2 Instructor
- ▶ 6 Research Assistants

# History

- ▶ Undergraduate education has been launched in 1995.
- ▶ Alumni: 410
- ▶ Current undergraduate students: 254
- ▶ Graduate education has been launched in 2001.
- ▶ Alumni: 29
- ▶ Current graduate students : 42
- ▶ The department has been altered its education language to 30% English as of 2010.



# Academic Staff



# Academic Staff

## ► Textile Technology

Associate Prof. Dr. Sema PALAMUTÇU (Head of the Branch)

Associate Prof. Dr. Yıldıray TURHAN

Associate Prof. Dr. Nazire Deniz YILMAZ

Assistant Prof. Dr. Güngör DURUR

Assistant Prof. Dr. Ali Serkan SOYDAN

Instructor Ayşe ÖZKAL

Research Assistant Volkan KAPLAN(PhD)

Research Assistant Kenan YILMAZ

Research Assistant Görkem GEDİK



# Academic Staff

## ► Textile Sciences

Associate Prof. Dr. Yüksel İKİZ (Head of the Branch)

Associate Prof. Dr. Ozan AVİNÇ

Assistant Prof. Dr. Arzu ÖZERDEM

Assistant Prof. Dr. Nurhan ONAR

Assistant Prof. Dr. Reyhan KESKİN

Instructor Nalan DEVRENT

Research Assistant Nilüfer VARAN (PhD)

Research Assistant Dr. Buket ARIK (PhD)

Research Assistant Barış HASÇELİK



# Academic Staff



Assoc. Prof. Dr. Sema PALAMUTÇU  
Head of the Department  
Head of the Main Branch of Textile Technology

Graduation

B.S.

Istanbul Technical University

M.Sc.

Philadelphia University

Ph.D.

Ege University



# Academic Staff



Assoc. Prof. Dr. Ozan AVINÇ

Graduation

B.S.

Ege University

M.Sc.

Katholieke University

Ph.D.

Manchester University



# Academic Staff



Assoc. Prof. Dr. Yıldıray TURHAN

Graduation

B.S.

Ege University

M.Sc.

Ege University

Ph.D.

Uludag University

# Academic Staff



**Assoc. Prof. Dr. Yüksel İKİZ**  
**Head of the Main Branch of Textile Sciences**

Graduation

B.S.

Uludag University

M.Sc.

Philadelphia University

Ph.D.

North Carolina State University

# Academic Staff



**Assoc. Prof. Dr. Deniz YILMAZ**  
**Erasmus Coordinator of the Department**

Graduation

B.S.

Pamukkale University

M.Sc.

Pamukkale University

Ph.D.

North Carolina State University

# Academic Staff



Assistant Prof. Dr. G ng r DURUR

## Graduation

B.S.

Ege University

M.Sc.

Leeds University

Ph.D.

Leeds University

# Academic Staff



Assistant Prof. Dr. Arzu ÖZERDEM

Graduation

B.S.

Ege University

M.Sc.

Ege University

Ph.D.

Ege University

# Academic Staff



Assistant Prof. Dr. Nurhan ONAR

Graduation

B.S.

Ege University

M.Sc.

Dokuz Eylul University

Ph.D.

Dokuz Eylul University

# Academic Staff



Assistant Prof. Dr. Reyhan KESKİN

Graduation

B.S.

Pamukkale University

M.Sc.

Pamukkale University

Ph.D.

Auburn University



# Academic Staff



Assistant Prof. Dr. Ali Serkan SOYDAN

Graduation

B.S.

Pamukkale University

M.Sc.

Dokuz Eylul University

Ph.D.

Dokuz Eylul University

# Academic Staff



Instructor Nalan DEVRENT

Graduation

B.S.

Ege University

M.Sc.

Pamukkale University

# Bölüm Akademik Kadrosu

	Instructor Ayşe ÖZKAL	
Graduation	B.S.	Istanbul Technical University
	M.Sc.	Uludağ University

# Academic Staff



Research Assistant Dr. Nilüfer VARAN

Graduation

B.S.

Pamukkale University

M.Sc.

Pamukkale University

Ph.D.

Istanbul Technical University

# Academic Staff



Research Assistant Dr. Buket ARIK

Graduation

B.S.

Ege University

Joint Ph.D.

Ege University

# Academic Staff



Research Assistant Volkan KAPLAN

Graduation

B.S.

Pamukkale University

M.Sc.

Pamukkale University

Ph.D.

Suleyman Demirel University

# Academic Staff



Research Assistant Barış HASÇELİK

Graduation

B.S.

Pamukkale University

M.Sc.

Pamukkale University

Ph.D.

Uludag University (continuing)



# Academic Staff



Research Assistant Kenan YILMAZ

Graduation

B.S.

Pamukkale University

M.Sc.

Pamukkale University

Ph.D.

Suleyman Demirel University (continuing)

# Academic Staff



Research Assistant Görkem GEDİK

Graduation

B.S.

Cukurova University

M.Sc.

Pamukkale University

Ph.D.

Dokuz Eylul University (continuing)

# Our Mission

- ▶ To educate internationally competitive young textile engineers who are modern, rational and respectful to both environment and society.
- ▶ To contribute to textile science and technology.
- ▶ To have a part in scientific, technologic, and economic development of our country.



# Our Vision

- ▶ To be a prestigious global education and research institution that ultimately contributes to the production, use and dissemination of the information in the field of textile engineering and put the know-how into use of sectoral needs.



# Universities having ERASMUS Bilateral Agreement with PAU

- ▶ Technical University Liberec/ Czech Republic
- ▶ Valencia University / Spain
- ▶ Université Lille / France
- ▶ Lodz Technical University / Poland
- ▶ University of Maribor / Slovenia
- ▶ Kaunas University of Technology / Lithuania
- ▶ Universitatea Din Oradea / Romania
- ▶ Saxion University of Applied Sciences / Holland



# Overseas Education

	2004-2013	Countries
Student Mobility for Placements (Outgoing)	51	Czech Republic, France, Lithuania, Poland, Romania, Spain
Student Mobility for Placements (Incoming)	6	France, Poland
Internship Mobility	6	Spain, Lithuania
Teaching Staff Exchange	17	Spain, Poland
Staff Training Mobility	2	Germany

# Laboratories & Testing Facilities

- ▶ Physical Testing Laboratory
- ▶ Textile Finishing Laboratory
- ▶ Textile Science Laboratory
- ▶ Apparel Workplace
- ▶ Printing Workplace
- ▶ Weaving Workplace



# Physical Testing Laboratory

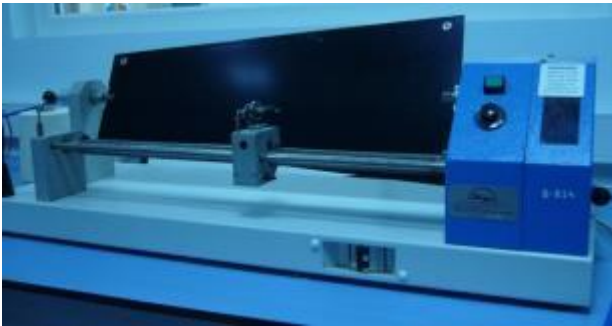

- Tensile tester
- Yarn strength tester
- Tear strength tester
- Crockmeter / Rubbing fastness tester
- Rewinding machine
- Spray rating tester
- Fabric drape tester
- Twist tester
- Board winder



# Physical Testing Laboratory

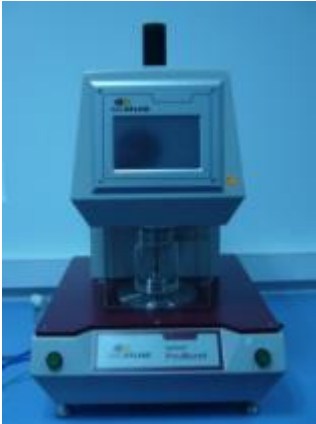

- Burst strength tester
- Martindale abrasion and pilling tester
  - Elmandorf tear strength tester
    - Perspiration Tester
- Water Resistance Tester
- Water Penetration Tester
  - Motorized Wrap Reel
    - Yarn Inspector

# Textile Finishing Laboratory

- Foulard
- Stenter
- Sample dyeing machines
- Lab oven / Incubator
- Light booths / Color matching Cabinets
- Cone dyeing machine
- Cone drying machine



# Textile Finishing Laboratory

- Ultrasonic bath
- Water / Sand baths
- Steamer
- Screen printing machine
- Wascator washer-extractor





# Textile Science Laboratory

- Spectrophotometer
- UV spectroscopy
- Nanofibre fabrication system



# Apparel Workplace



# Other Workplaces

- ▶ Rewinding machine
- ▶ Sample weaving machine
- ▶ Doubler-winder
- ▶ Twister
- ▶ Wrap Reel
- ▶ Mechanical mixer
- ▶ Viskosimeter





# Activities

- Technical visits
- Career days
  - Seminars
- Conferences
  - Workshops
- Student club activities



# Visitors



# Technical Visit to a Weaving Factory



# Communication Seminars





# 2<sup>nd</sup> International Textile & Apparel Summit



# Student Club











# Career Day 2010



# Career Day 2011, 12 May 2011



# Career Day 2013, 13 May 2013





# Graduation Ceremony, June 2013







# Access

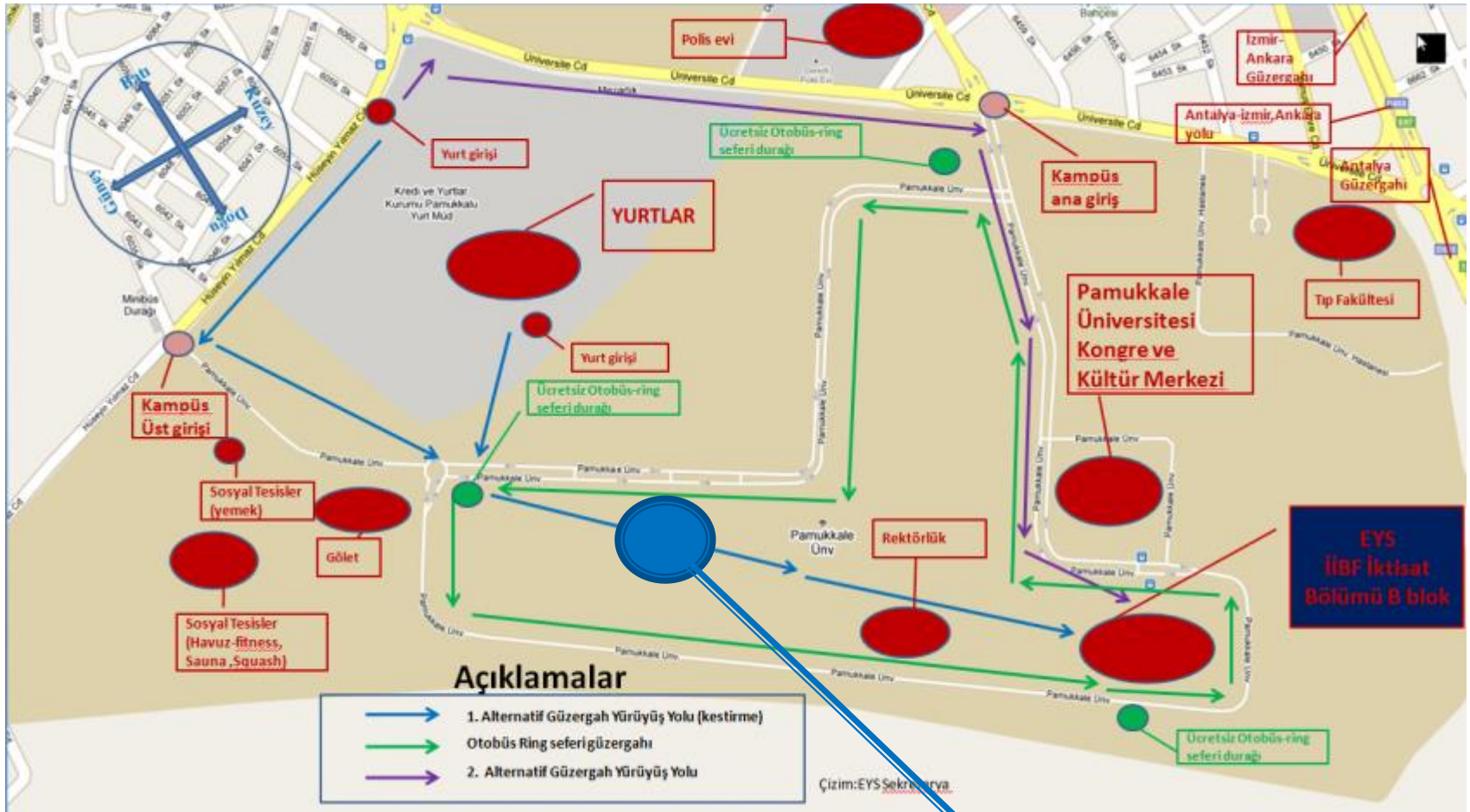

Faculty of Engineering



# Pamukkale University Faculty of Engineering Department of Textile Engineering



Address: Kınıklı Yerleşkesi, 20070 Denizli /Türkiye

Phone: +90 (258) 296 31 01

Fax: +90 (258) 296 32 62

E-mail: [tekstil@pamukkale.edu.tr](mailto:tekstil@pamukkale.edu.tr)

Web: <http://www.pau.edu.tr/tekstil/en>



**2013-2014**

***PAU Faculty of Engineering***